



A Met-Pro Fluid Handling Technologies Business

# Dean Pump® Series FW

## Vertical/Horizontal Water Pumps



# Introducing the NSF® Certified Dean Pump® Series FW 1200 Water Pump

*Designed specifically for  
pumping water, the  
Series FW is available  
in both **vertical and  
horizontal configurations***



## Features

- Two pump sizes
- Ductile iron construction
- Capacities to 3200 GPM (727 m<sup>3</sup>/hr)
- Heads to 155 feet (47 m)
- Working pressures to 100 psig (690 kPa)
- Pumping temperatures to 250°F (121°C)

## Typical Applications

- Pools
- Hotels/resorts
- Water parks
- Industrial/municipal



Certified to  
NSF/ANSI Standard 50



Sea World  
San Antonio, TX  
BETA Site Installation

## Horizontal Configuration

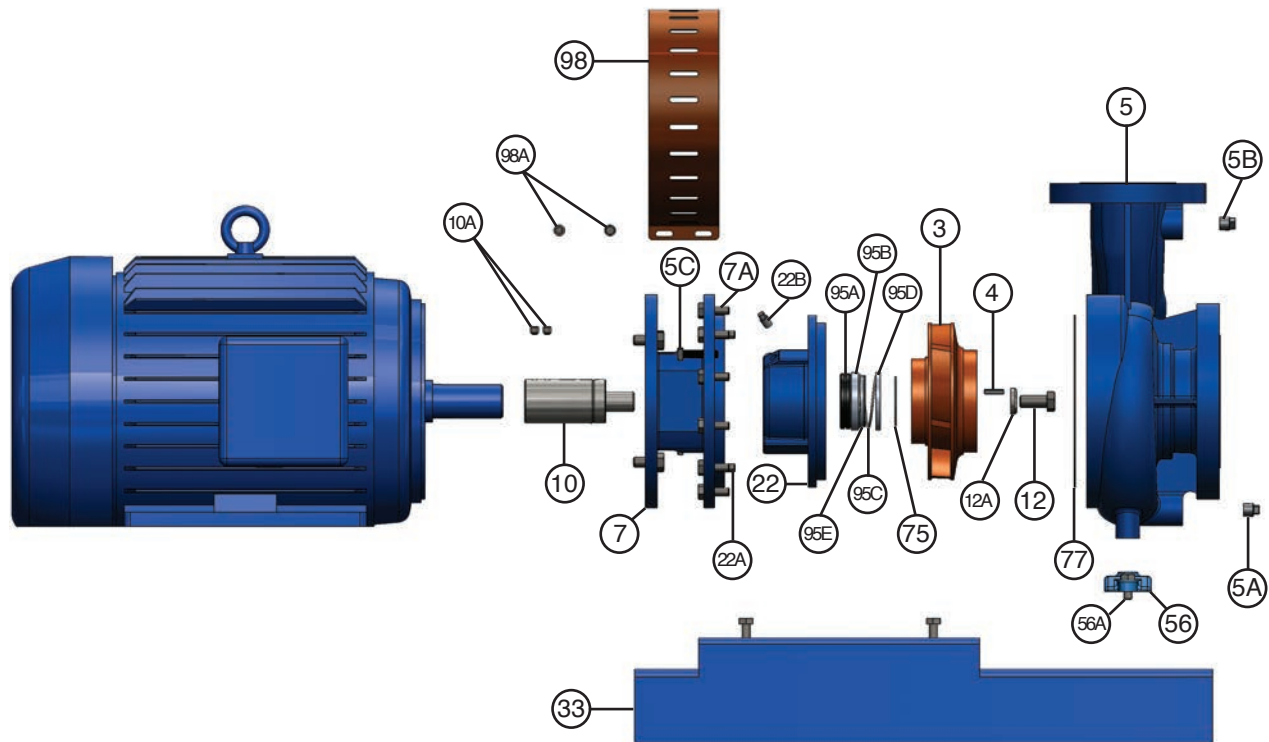

### STANDARD MATERIALS OF CONSTRUCTION

FW 1200 Series		
Part No.	Part Name	Standard Material
3	Impeller	Bronze
4	Impeller Key	Steel
5	Casing	Ductile Iron
5A	Casing Drain Plug	Steel
5B	Discharge Gauge Plug	Steel
5C	Jack Screw	Steel
7	Cradle	Cast Iron
7A	Cradle Bolts	Steel
10	Shaft Extension	316SS
10A	Shaft Fasteners	Steel
12	Impeller Bolt	Steel
12A	Impeller Washer	Steel
22	Backhead	Ductile Iron
22A	Backhead Bolts	Steel
22B	Vent Plug	Steel
33	Bent Steel Baseplate	Steel
56	Casing Foot	Cast Iron
56A	Casing Foot Bolts	Steel
75	Snap Ring	Steel
77	Casing Gasket	Teflon
95A	Mech Seal Stationary	Ceramic
95B	Mech Seal Rotary	Carbon
95C	Spring	316SS
95D	Retainer	316SS
95E	Bellows	Buna-N
98	Shaft Guard	Steel
98A	Shaft Guard Bolts	Steel

## Vertical Configuration

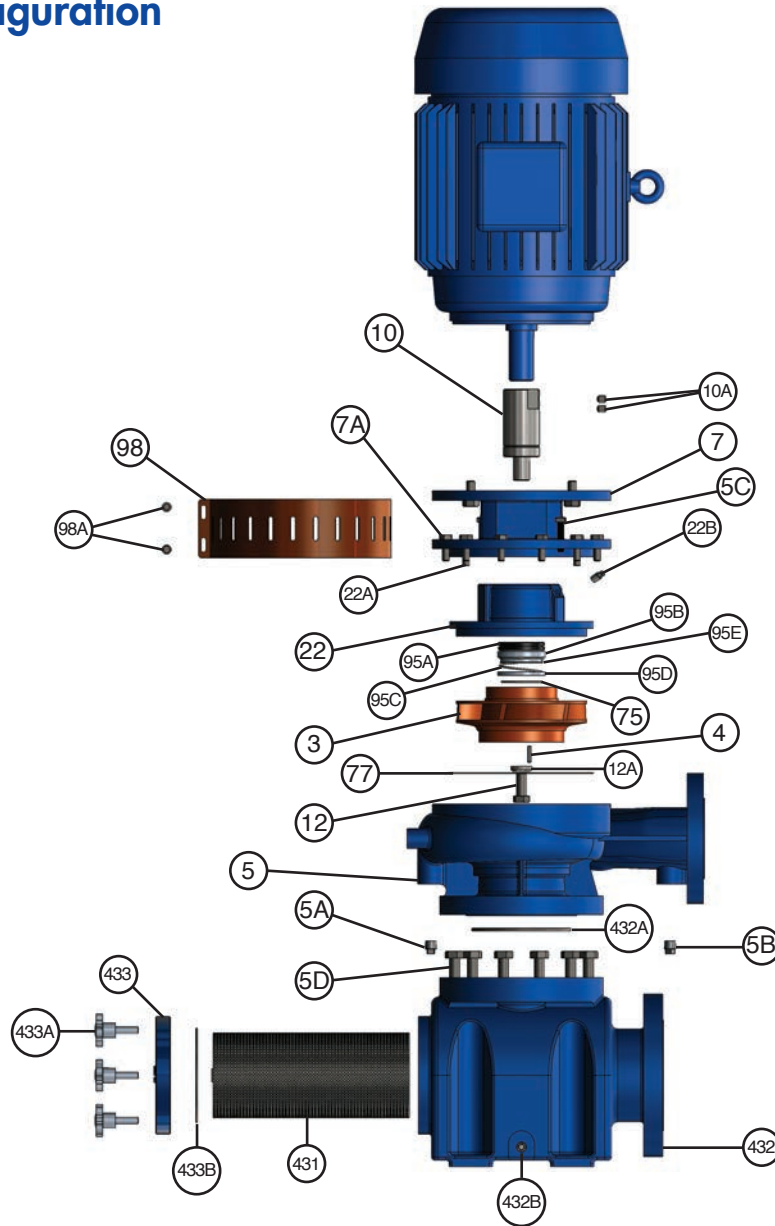

### STANDARD MATERIALS OF CONSTRUCTION

FW 1200 Series			FW 1200 Series		
Part No.	Part Name	Standard Material	Part No.	Part Name	Standard Material
3	Impeller	Bronze	75	Snap Ring	Steel
4	Impeller Key	Steel	77	Casing Gasket	Teflon
5	Casing	Ductile Iron	95A	Mech Seal Stationary	Ceramic
5A	Casing Drain Plug	Steel	95B	Mech Seal Rotary	Carbon
5B	Discharge Gauge Plug	Steel	95C	Spring	316SS
5C	Jack Screw	Steel	95D	Retainer	316SS
5D	Casing Bolts	Steel	95E	Bellows	Buna-N
7	Cradle	Cast Iron	98	Shaft Guard	Steel
7A	Cradle Bolts	Steel	98A	Shaft Guard Bolts	Steel
10	Shaft Extension	316SS	431	Strainer	304SS
10A	Shaft Fasteners	Steel	432	Strainer Tank	Cast Iron
12	Impeller Bolt	Steel	432A	Tank Gasket	Buna-N
12A	Impeller Washer	Steel	432B	Tank Drain Plug	Steel
22	Backhead	Ductile Iron	433	Strainer Tank Cover	Steel
22A	Backhead Bolts	Steel	433A	Cover Bolts	Steel
22B	Backhead Vent Plug	Steel	433B	Cover Gasket	Buna-N

## Optional Epoxy Coating



Standard bronze impeller  
material of construction



Optional epoxy coated  
impeller – Scotchkote™ 134

Scotchkote™ 134 is an option for all internal (wetted) pump surfaces. The coating meets NSF® standards and is designed for the corrosion protection of metallic components.

## Optional Integral Strainer Basket\*

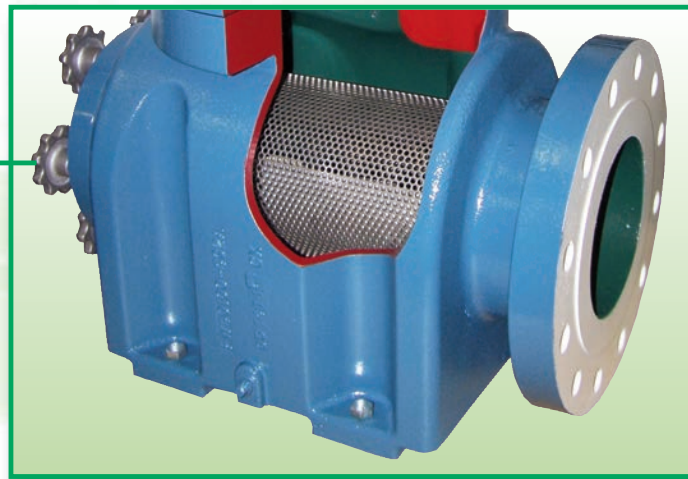

### ***Easy Installation and Operation***

- Large easy-grip hand knobs for strainer tank cover removal
- No tools required for strainer basket cleaning/change-out
- Stainless steel strainer basket for corrosion protection and durability

\*Available for vertical configuration only.

## Specifications

Series	FW	
Size	4 x 6 x 10	6 x 8 x 12.5
Max. Flow (1750 RPM)	1300 GPM (295 m <sup>3</sup> /hr)	3200 GPM (727 m <sup>3</sup> /hr)
Max. TDH (1750 RPM)	95 ft. (29 m)	155 ft. (47 m)
Operating Temp.	AMBIENT	AMBIENT
Max. Suction Pressure	50 PSIG (345 kPa)	50 PSIG (345 kPa)
Max. Working Pressure	100 PSIG (690 kPa)	100 PSIG (690 kPa)
Max. Power (1750 RPM)	50 hp (37 kW)	125 hp (93 kW)
Max. Power (1150 RPM)	15 hp (11 kW)	30 hp (22 kW)
Material	Ductile Iron	Ductile Iron
Applications	Water	Water

### ABOUT MET-PRO GLOBAL PUMP SOLUTIONS

Met-Pro Global Pump Solutions, which combines the resources of the Company's internationally recognized Dean Pump®, Fybroc® and Sethco® brands, is a leading niche-oriented global provider of solutions and products for the pumping of corrosive, abrasive and high temperature liquids. Its broad range of high quality centrifugal pumps provide excellent performance for tough applications including pumping of acids, brines, caustics, bleaches, seawater, high temperature liquids and a wide variety of waste liquids for a broad range of applications including the chemical, petrochemical, metal finishing, wastewater treatment, desalination and aquarium/aquaculture markets. For more information, visit [www.mp-gps.com](http://www.mp-gps.com)

### ABOUT MET-PRO

Met-Pro Corporation is a global provider of solutions and products for product recovery, pollution control and fluid handling applications. The Company's products include filtration and purification equipment for air, water and harsh, corrosive applications; fluid handling equipment for water, corrosive, abrasive, and high temperature liquids; and proprietary water treatment chemicals. For more information, visit [www.met-pro.com](http://www.met-pro.com).



A Met-Pro Fluid Handling Technologies Business

